

# VICTORIA

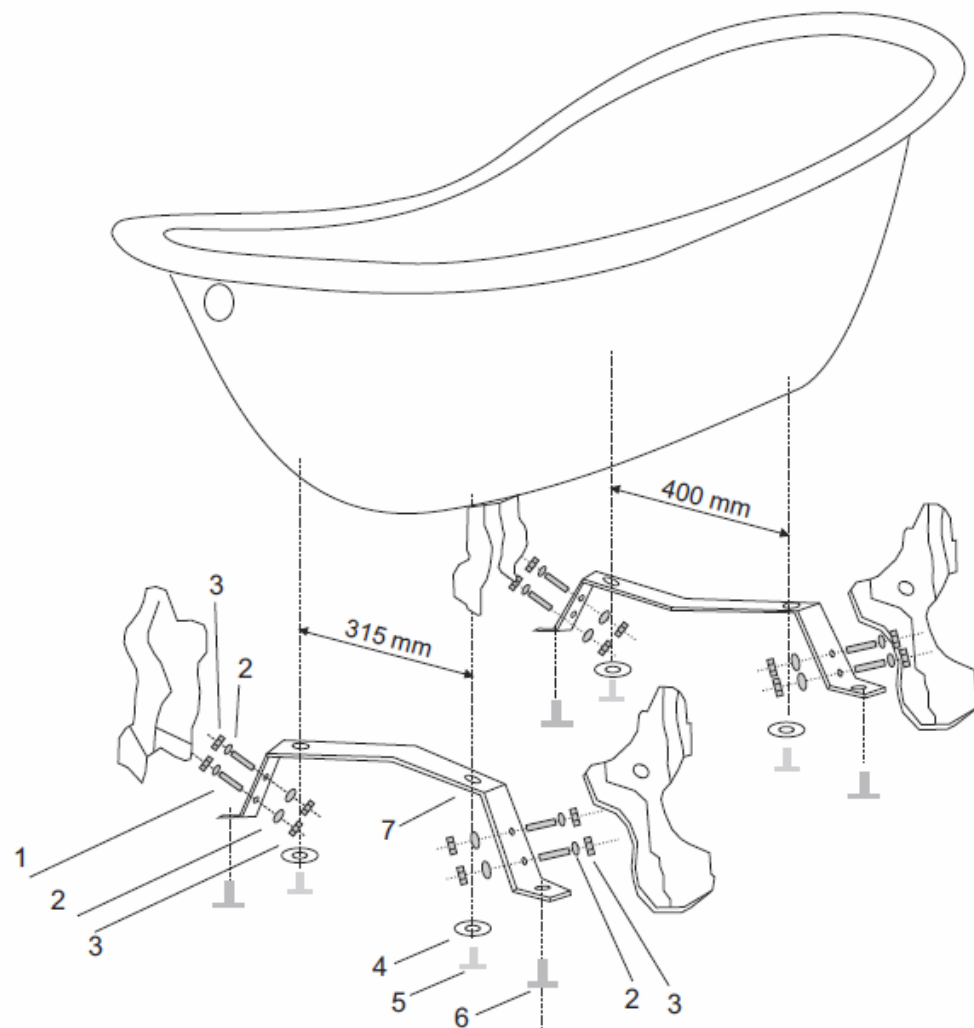

## MOUNTING SCHEME

1. Allen screw set 6x30	8 pcs.
2. Washer M6	8 pcs.
3. Nut M6	8 pcs.
4. Washer M10	4 pcs.
5. Screw 10x30	4 pcs.
6. Level set	4 pcs.
7. Frame	2 pcs.